

FR1300

RS485 Slave Reader
Reads Fingerprint,
RFID and Password



FR1300 is an indoor slave reader with RS485 interface that works with master controllers from ZKTeco, for example, inBIO series biometric control panels. As a value-added slave reader, FR1300 provides the most secure and cost effective access control solution for small and medium enterprises.

Feature

- Energy-saving, auto-sleep ZK infrared fingerprint sensor
- Built-in RFID card reader
- Supports password when working with inBIO series control panels
- LED and Buzzer prompt
- With doorbell function
- 86cmx86cm socket installation, easy operation

Specifications

Sensor	ZK Infrared Optical Sensor
Communication	RS485
Built-in Card Reader	125 kHz EM card reader, Optional Mifare card reader
Optional Function	Mifare Card Module
Power Supply	DC 12V
Operating Temperature	0°C ~ 45°C
Operating Humidity	20% ~ 80%
Dimension	88mm×88mm×33.6mm

Configuration

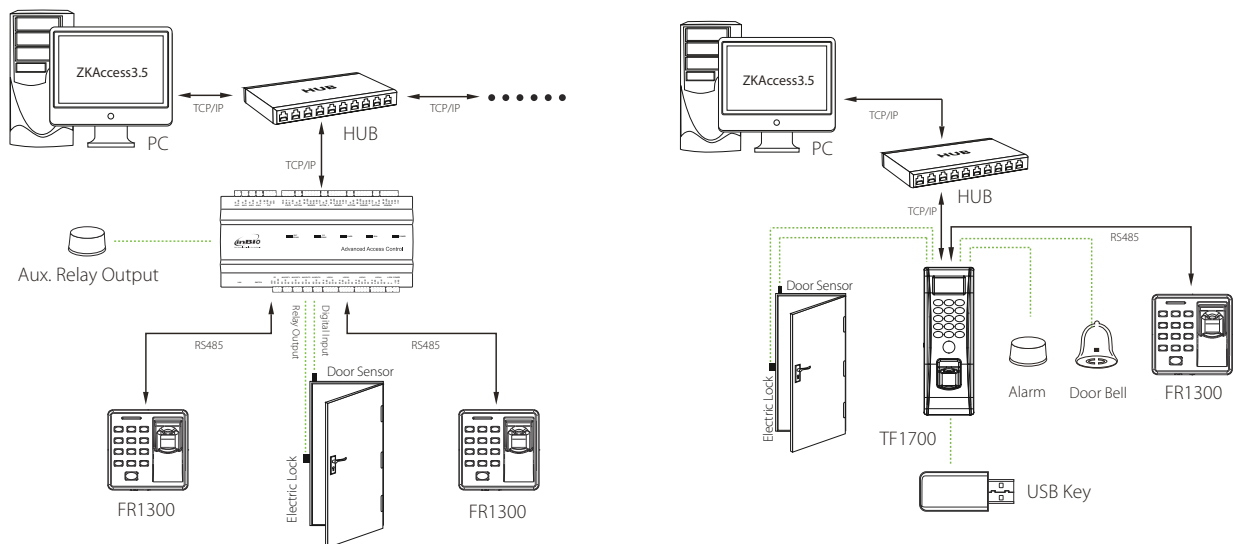

ZKTeco Inc.

ZK Mansion, Wuhe Rd, Gangtou, Bantian, Buji Town,
Longgang District, Shenzhen China 518129
Tel: 86-755-8960 2345/46/47/48
E-mail: sales@zkteco.com
www.zkteco.com

Global Offices:

USA: +1 732-412-6007
EU: +34 916532891
Brazil: +55 31 2515-8326
Thailand: +66-027199154
Mexico: +52-55-52928418

South Africa: +27 12 259 1047
Egypt: +201110444134
Dubai: +971 4 6091 310
India: +91 8123536788
Indonesia: +62 21 2921 8949

Vietnam : +84-0169-5813007
Philippines: +63 9084118832
Russia: +8 915 178-46-81