

Panasonic Video Door Phones

AmpleTrails
9315441078

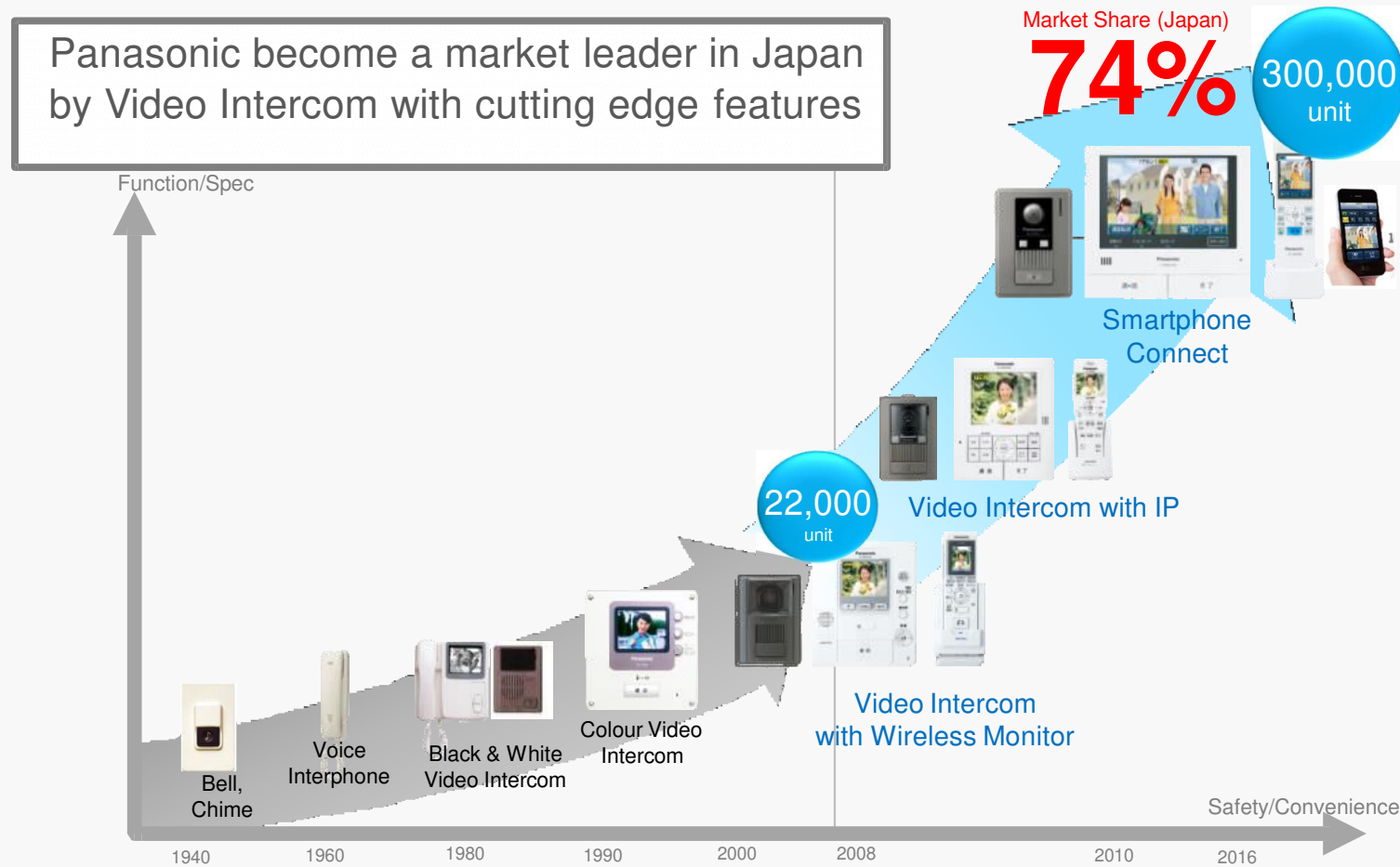

Panasonic: No.1 market share holder in Japan



Smart Door Bell (VL-VBN500SX)



Smart Wi-Fi door bell



Pana Bell
(APP for IOS and Android)

Smart Door Bell (VL-VBN500SX)

Model No.: VBN500SX

SPECIFICATIONS:

- Wi-Fi CONNECTION, EASY VIEW VIA MOBILE
- 7 DAYS FREE CLOUD STORAGE FOR 20 SHORT VIDEO RECORDS
- RECEIVE MESSAGES FROM THE DOORBELL BY APP
- 8S VIDEO RECORDS FOR THE CALLING
- UP TO 4 USERS ONLINE SIMULTANEOUSLY
- EXTENDABLE UP TO 32GB SD CARD
- PIR MOTION DETECTION FUNCTION
- IR NIGHT VISION (IR CUT CAMERA LENS)
- VIDEO RESOLUTION: 720P
- VIEW ANGLE: 100°
- LAST FOR 6 MONTHS WITH LOW CONSUMPTION
- IP54 WATER PROOF
- BUILT IN 4000mAh POLYMER BATTERY
- UNLOCKING FUNCTION



Smart Door Bell (VL-VBN500SX)

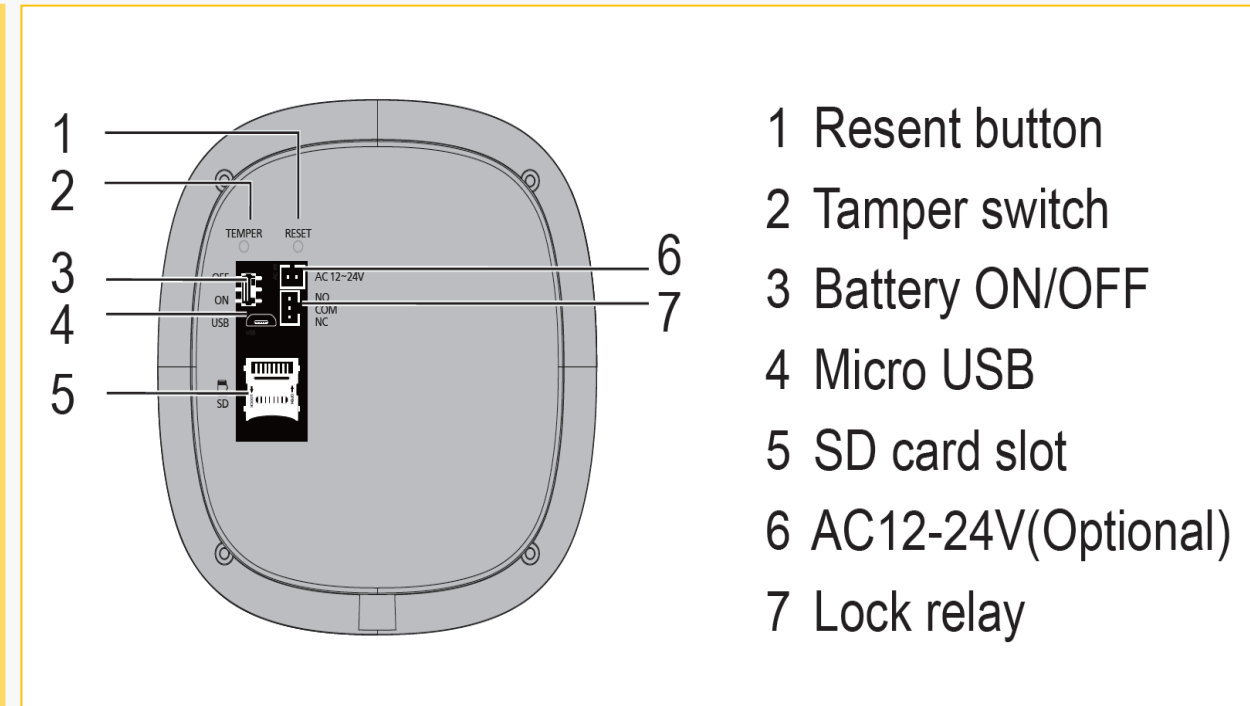
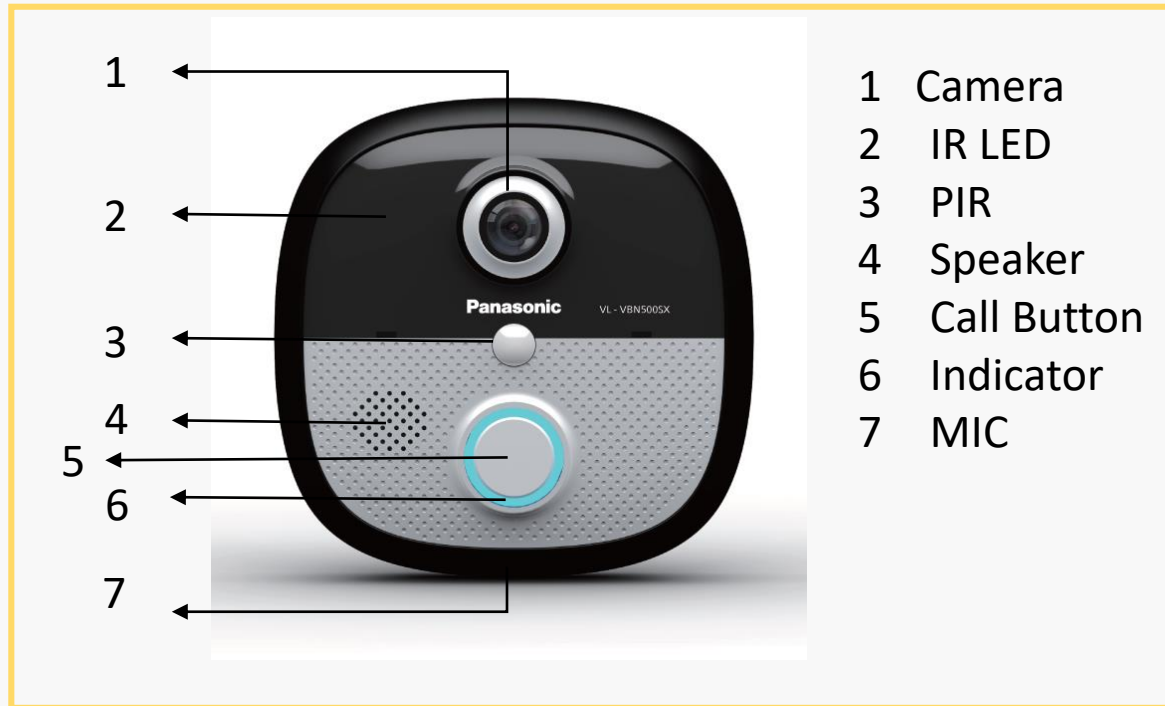

Note:

- **AC12-24V port** is used for connecting the AC/DC12-24V power source.
(Please don't connect to AC220V power directly, otherwise it will burn the circuit board and cause fire.)
- **Lock relay:** Support connecting NO or NC door lock.

Smart Door Bell (VL-VBN500SX)

1. Wireless connection and easy view via mobile app (Pana Bell).

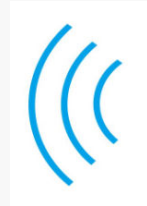

Cloud server (Amazon...)

Internet

Internet

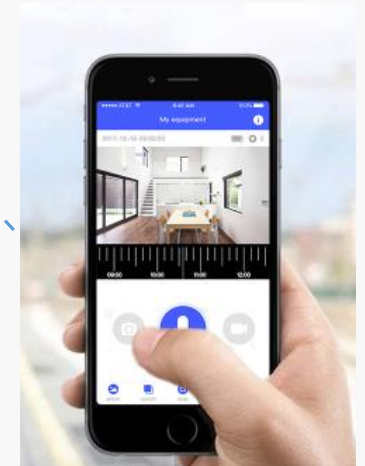

- **7 days free cloud storage for 20 short video (Each video last for 8 seconds)**
- Supports Max.32GB SD card for video and picture records and play back on APP.
- Remote control the doorbell via mobile app.

Smart Door Bell (VL-VBN500SX)

2. Receive message from the doorbell on APP

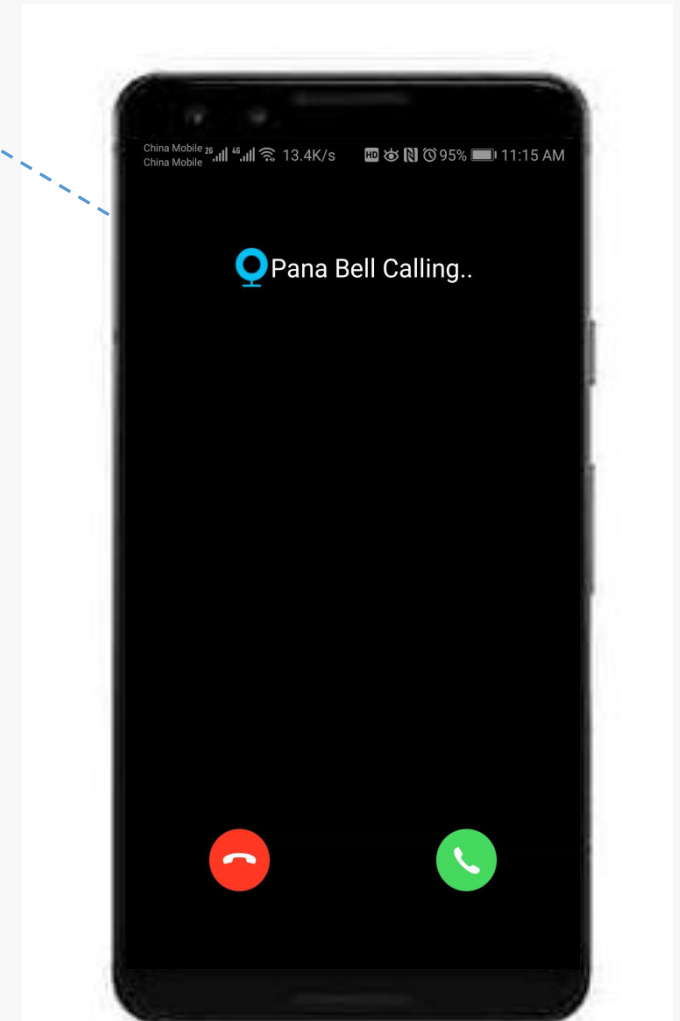

- After visitor presses the call button, it will ring your mobile phone app.
(Pushing a message or phone call for option)
- Once PIR detect the motion, it will ring your mobile as well.
- You can build 2-way intercom with your visitor by accepting the call on app.

Smart Door Bell (VL-VBN500SX)

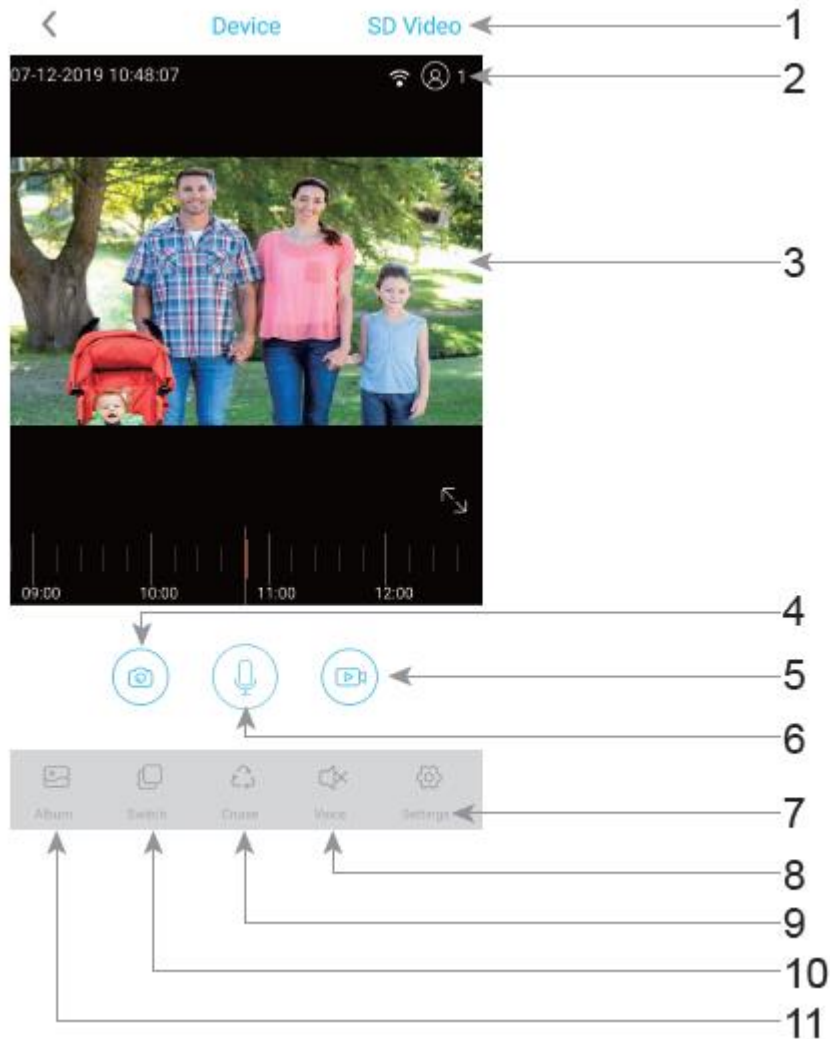

- 1 SD/HD toggle
- 2 Live Wi-Fi, battery and connection info.
- 3 Live video feed
- 4 Snapshot
- 5 Video record
- 6 Live 2-way speech
- 7 Settings (Enter to adjust PIR, night mode etc)
- 8 Voice mute
- 9 Cruise from left to right in zoom mode
- 10 Switch between standard and zoom mode
- 11 View photo album (on device or cloud storage)

Smart Door Bell (VL-VBN500SX)

3. IR Cut Camera lens

- **The device will detect the environment light to switch the IR filter.**
(In daily, the picture is colorful, In night, there will be B/W picture)

4. Release door lock remotely

- **Input password to release the door lock on APP**
- **Support NO or NC door lock**
(Lock wiring is as below)

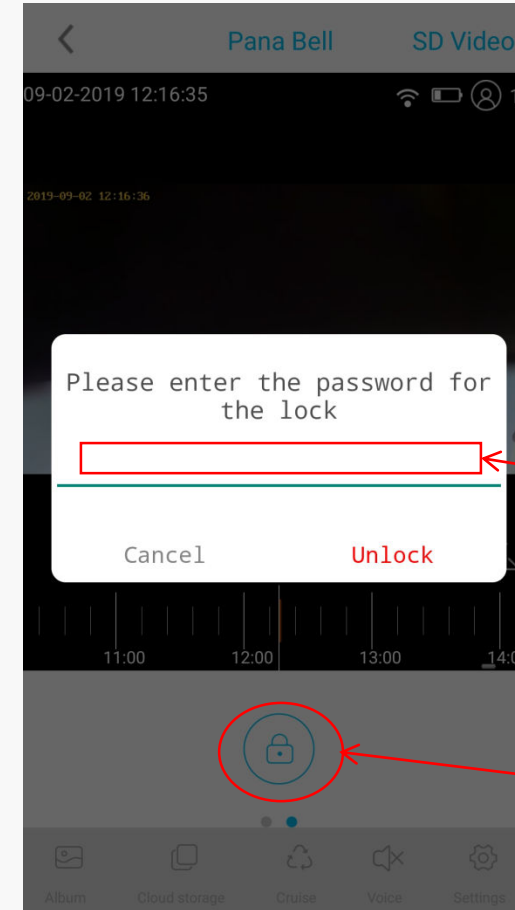
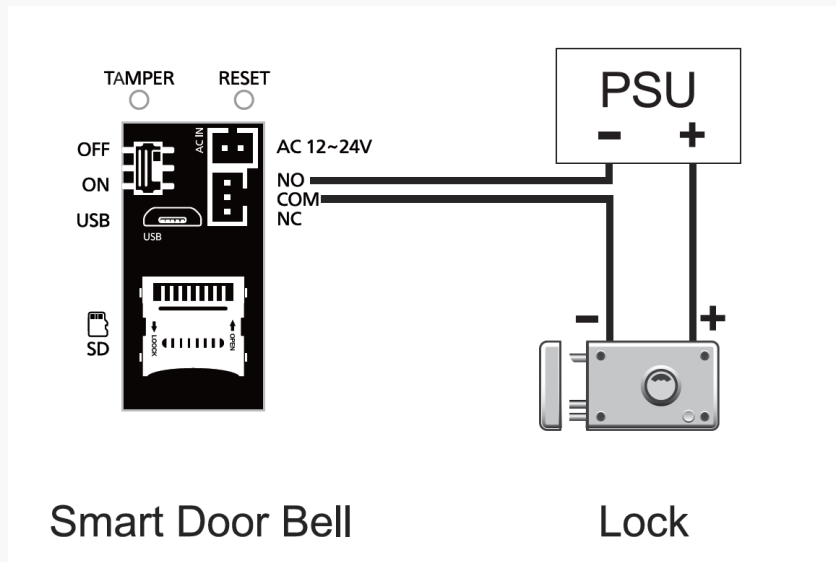

Input password for unlocking.
Default Password: 666666

Unlocking button.

Smart Door Bell Chime Device (VL-VBC501SX)

New



Chime device enables local notification from doorbell even without internet.

Volume	100 db (max)
Sensitivity	-110 dbm
Frequency	433.92 MHz \pm -280 KHz
Power consumption	10 mW
Power: mains	100~240 Vac
Dimensions	82 x 82 x 27 mm
Weight	70 g

Available for Sale in Jun*

THANK YOU

info@ampletrails.com

<https://ampletrails.com/panasonic-video-door-phone-vdp>